



The Columbia - Bi-Level
3 (or 5) Bedrooms
2 (or 3) Bathrooms
1,450 (or 2,184) Sq. Ft.

Encore[™]
MASTER BUILDER
EXPECT TO BE IMPRESSED



TEL: 780-472-8362
FAX: 780-472-8343



info@encorehomes.ca
EncoreHomes.ca



11344 - 119 Street
Edmonton, AB T5G 2X4

3 (or 5) Bedroom - Bi-Level

2 (or 3) Bathrooms

1,450 (or 2,184) Sq.Ft.

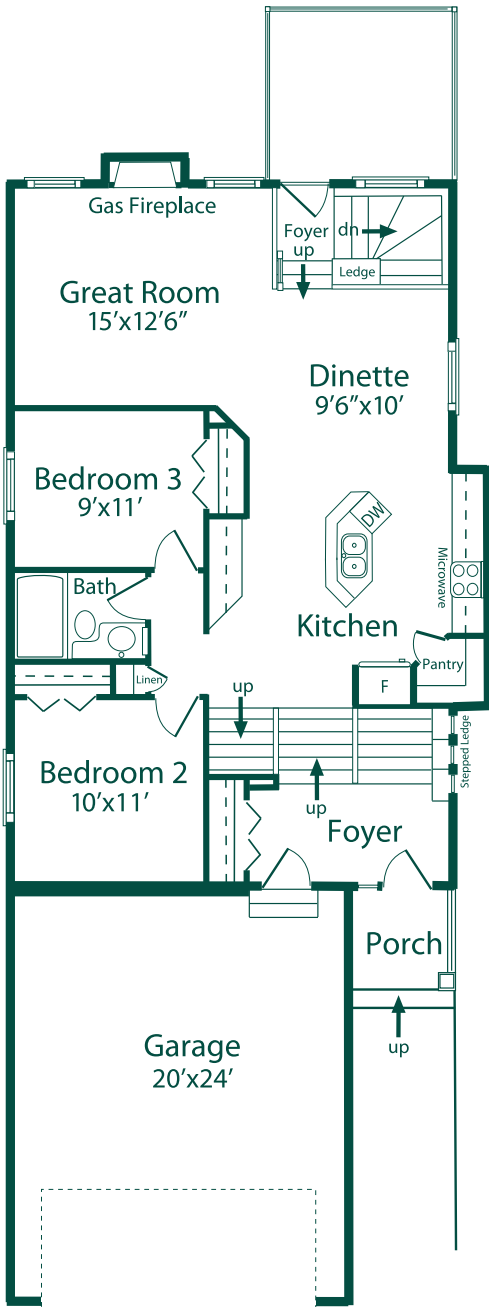

Main Level
1,094 sq.ft.

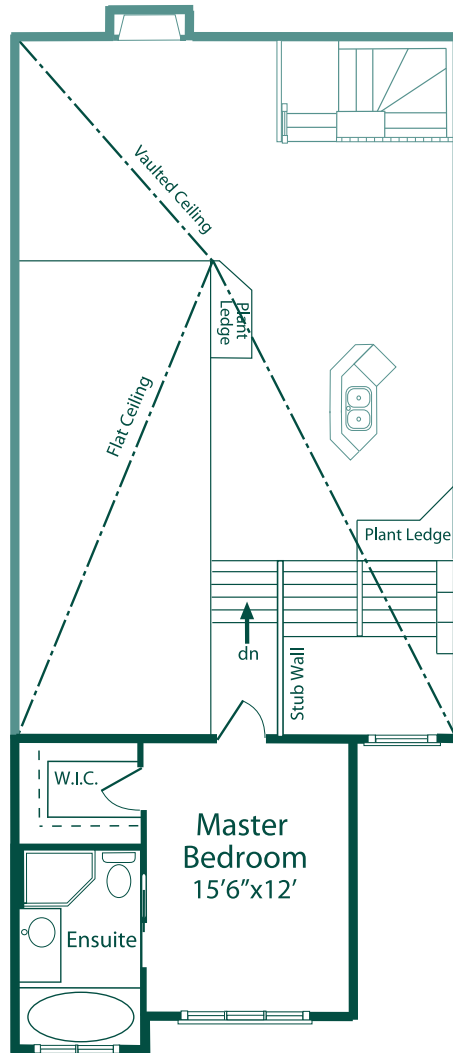

Upper Level
356 sq.ft.

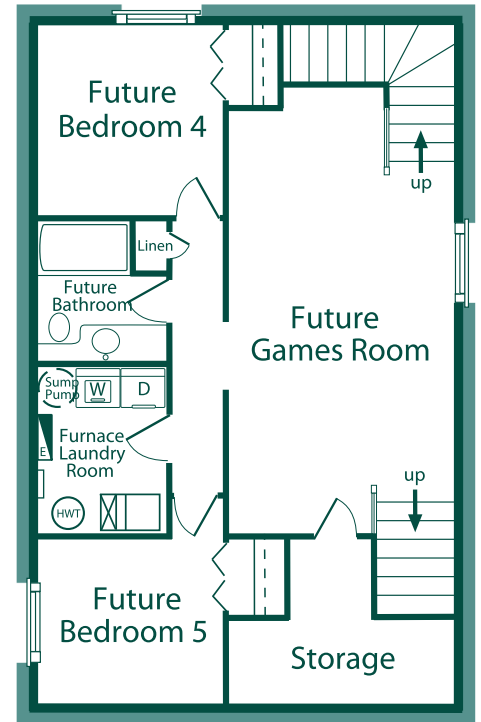

Lower Level
(Optional Development)
734 sq.ft.